

Heating element type **KD** *economy*

Used material: vertical D profile - 30x40 mm
horizontal profile - straight tube, diameter 20mm

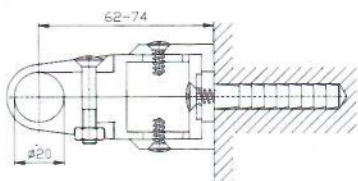

plastic holder

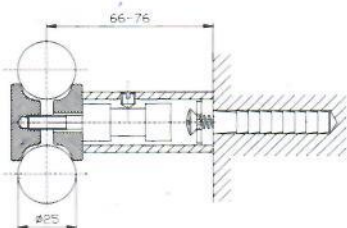

metal holder
for extra payment

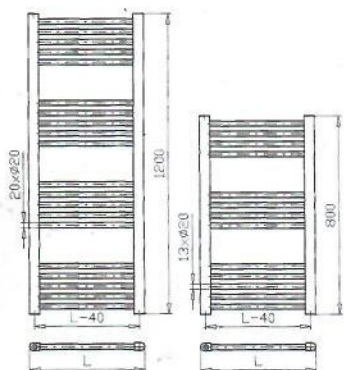
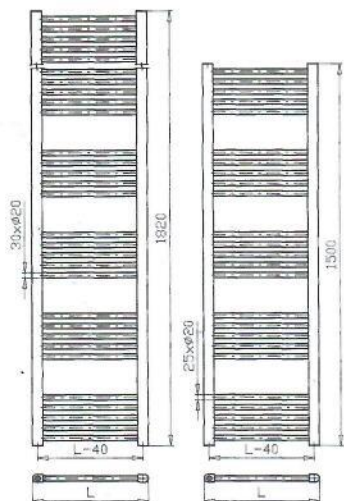

Heater power Q[W] for heat-transfer substance water according to DIN EN 442

Type description	Height H [mm]	Lenght L [mm]	Thread pitch [mm]	t ₁ /t ₂ [°C]	Q[W] pro t ₁ [°C]			Thermal exponent n [-]	Water volume n [l]	Rec. Radiator input power [W]	
					18	20	22				
KD 400 / 800	800	400	360	90/70	339	325	311	1,24246	3,5	200	
KD 450 / 800				410	75/65	272	259				246
					55/45	149	137				126
		600	560		90/70	372	357	342	1,24246	3,65	200
75/65				299	284	271					
55/45				164	151	139					
KD 600 / 800		600	560	90/70	468	449	431	1,24246	4,15	300	
				75/65	376	358	340				
				55/45	206	190	174				
KD 750 / 800		750	710	90/70	559	537	515	1,24246	4,65	300	
				75/65	449	428	406				
				55/45	245	226	208				
KD 400 / 1200	1200	400	360	90/70	516	495	475	1,24251	5,3	300	
				75/65	415	395	376				
				55/45	227	210	192				
KD 450 /1200		450	410	90/70	567	544	522	1,24251	5,5	300	
				75/65	455	434	412				
				55/45	249	230	211				
KD 600 / 1200		600	560	90/70	713	685	657	1,24251	6,3	400	
				75/65	573	546	519				
				55/45	314	290	265				
KD 750 / 1200		750	710	90/70	852	818	784	1,24251	7,05	500	
				75/65	685	652	620				
				55/45	375	346	317				
KD 400 / 1500	1500	400	360	90/70	659	633	606	1,24256	6,6	400	
				75/65	530	504	479				
				55/45	290	267	245				
KD 450 /1500		450	410	90/70	724	695	666	1,24256	6,9	400	
				75/65	582	554	526				
				55/45	318	293	269				
KD 600 / 1500		600	560	90/70	911	874	838	1,24256	7,85	500	
				75/65	732	697	662				
				55/45	400	396	339				
KD 750 / 1500		750	710	90/70	1088	1044	1001	1,24256	8,8	600	
				75/65	874	833	792				
				55/45	478	441	405				
KD 400 / 1800	1800	400	360	90/70	802	770	738	1,2426	7,9	400	
				75/65	645	614	584				
				55/45	353	326	299				
KD 450 /1800		450	410	90/70	881	846	811	1,2426	8,3	500	
				75/65	708	674	641				
				55/45	387	357	328				
KD 600 / 1800		600	560	90/70	1109	1064	1020	1,2426	9,4	600	
				75/65	891	848	806				
				55/45	487	450	413				
KD 750 / 1800		750	710	90/70	1324	1271	1219	1,2426	10,6	700	
				75/65	1064	1014	964				
				55/45	582	538	493				

The heating performance data applies to one-side connection of top-down

thermal trend

spol. s r. o.

Starovičky 271
693 01 post - office Hustopeče u Brna
Czech Republic
Tel./fax: +420 519 414 032 / Tel.: +420 519 325 759
Mobil: +420 724 237 082
www.thermal-trend.cz
e-mail: thermal-trend@thermal-trend.cz

Your business partner :