

Product: KLUDI LOGO NEO single lever sink mixer DN 10

Ref.: 379130575

Product description

single lever sink mixer DN 10
solid lever
single hole mounted
flow class A
aerator M 24 x I
ceramic cartridge with hot water safety device
swivelling (360°) spout 200 mm
rapid installation set
flexible high pressure supply
tubes G 3/8
noise group I
P- IX 7526/IA

Finishes:
chrome

Product picture



Advertisement

- * KLUDI GmbH & Co KG KLUDI LOGO NEO single lever sink mixer DN 10 item no. 379130575
- ** ceramic cartridge with hot water safety device Ø 35 mm, DIN EN 817
- *** chrome plated brass, DIN 50930-6

single lever sink mixer, manufacturer KLUDI GmbH & Co KG KLUDI LOGO NEO single lever sink mixer item no. 379130575, DN 10, chrome plated brass, type: single lever sink mixer DN 10, swivel spout L = 200 mm, solid lever, lever projection 83 mm, aerator M 24 x I, noise level DIN EN 4109 group I, report no. P- IX 7526 / IA, flow class A (max. 0,25 l/s), nozzle projection 200 mm, rapid installation set, flexible high pressure supply tubes 3/8 inch with metal body with DVGW / KIWA / WRAS / CSTB length 365 mm, ceramic cartridge with hot water safety device Ø 35 mm, nozzle height 110/133 mm, overall length 141 mm, for pressure type water heater, for continuous line heater, PN 10,

Dimensional drawing

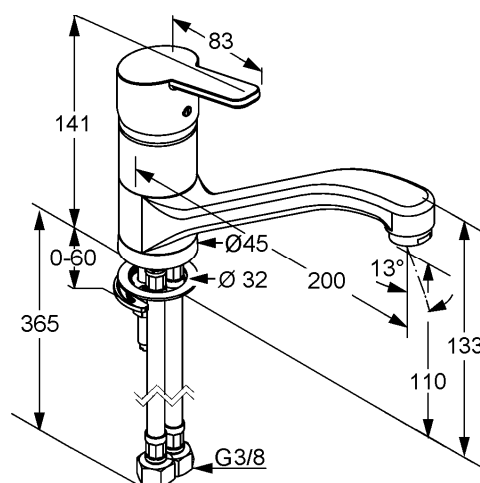

Flow rate diagram

