



- Deck mounted
- Single lever
- Chrome
- Fixed Spout
- Easy fix
- Double water inlet
- Plastic cartridge with heat and flow limiter
- Flexible hose with stainless steel braiding

Technical Data

Technical properties

Hot water supply	Max: 80 °C (Recommended: 5-65 °C)
Working pressure	0,1-0,4 Bar
Connection size	G 3/8"
Body material	Brass
Projection	114 mm
Spout height	78 mm

Certificates

DWGV confirmity

Regulations

EN standard **EN 817**

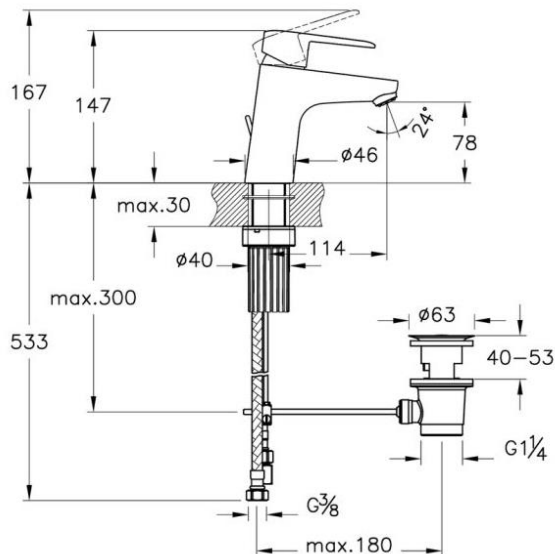

Spare Part List – A43497ND

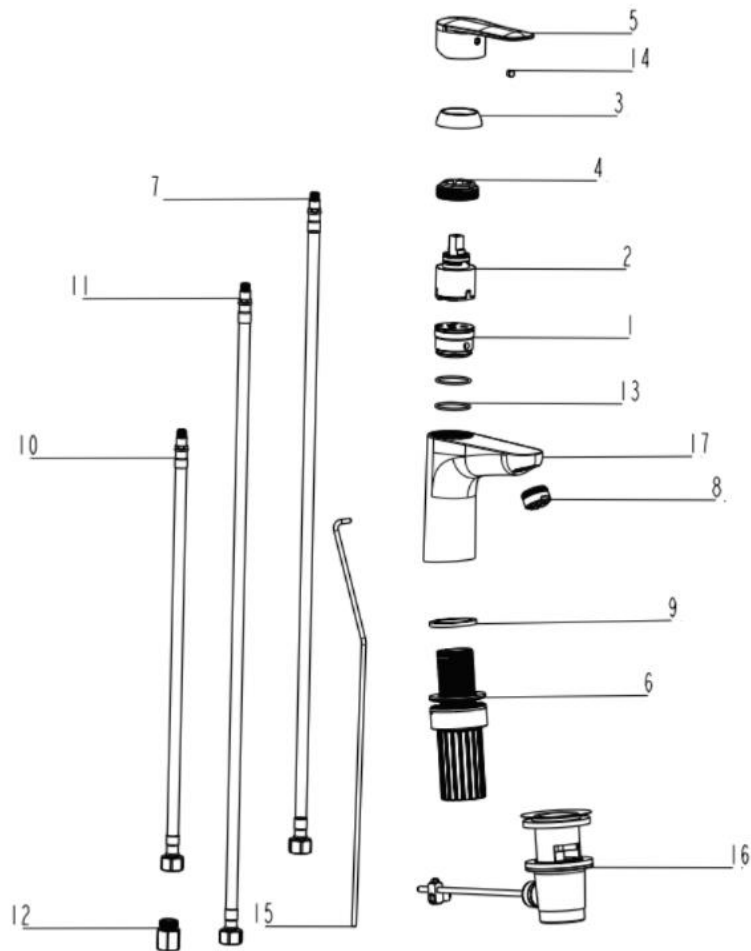

NO	CODE	DESCRIPTION	QUANTITY
1	A2163440YP	INNER BODY	1
2	A25334YP	Ø35 CARTRIDGE	1
3	A2461601YP	CARTRIDGE COVER	1
4	A2461740YP	RETAINING NUT	1
5	A3376201VD000RBYP	HANDLE	1
6	A36951YP	FIXING SET	1
7	A3237498YP	M8 3/8" FLEXIBLE HOSE	1
8	A3124101YP	M24X1 AERATOR	1
9	A24690YP	SEALING	1
10	A3237396YP	M8 3/8" FLEXIBLE HOSE	1
11	A3237496YP	M8 3/8" FLEXIBLE HOSE	1
12	A3190401YP	FLOW REGLUATOR	1
13	A22759YP	O-RING	2
14	A20697YP	HOLE CAP	1
15	A2246901YP	POP-UP ROD	1
16	A3255301YP	SYPHON	1