

EN

Table of contents

1	About this document	40
2	Safety	41
2.1	Purpose of the document	41
2.2	Intended use	41
2.3	User requirements	41
2.4	Electrical safety	41
2.5	Hygiene	43
2.6	Information on the use of the remote control with storage battery	43
2.7	Information on the use of batteries	44
2.8	Minor burns	45
2.9	Avoid product damage	45
3	Product overview	47
3.1	Structural and functional description	47
3.1.1	Seat unit	47
3.1.2	LED display on the seat unit	47
3.1.3	Functional area Pro	48
3.1.4	Functional area Plus/Lite	49
3.1.5	Seat sensor and opening descaling agent	49
3.2	Factory settings	50
4	Initial operation	51
4.1	Activate the remote control	51
4.1.1	Remote control with storage battery	51
4.1.2	Remote control with batteries	52
4.2	Switch product on	52
4.3	Download the app	53
4.4	Connect the app	53
4.5	Pairing remote control with shower toilet	54
4.6	Pairing remote control with electronic actuator plate*	55

5	Operation	56
5.1	Remote control/App	56
5.2	Open and close the cover	58
5.3	Set the user profile by remote control	58
5.4	Energy and water efficiency	58
5.4.1	Energy saving mode (seat heating)	58
5.4.2	Holiday mode	58
6	Cleaning and care	59
6.1	Safety	59
6.2	Cleaning recommendations	60
6.2.1	Cleaning	60
6.2.2	Recommended cleaning agents	60
6.3	Self-cleaning of spray wand and spray nozzle	60
6.4	Manual cleaning mode for the spray wand and spray nozzle	61
6.5	Descaling	61
7	Troubleshooting support	63
7.1	General information	63
7.2	Troubleshooting	63
8	Disposal	68
8.1	Packaging	68
8.2	WEEE	68
9	Technical data	69

1 About this document

All documents related to this product and further information are available online:

- > Access the quick guide in the app. [►App] Menu – Device guide – Quick guide
- > Access the online documents at qr.duravit.com or www.duravit.com and enter the article code in the search field.

2 Safety

2.1 Purpose of the document

The instructions are part of the Duravit product. Failure to follow the instructions may result in personal injury, product damage and/or property damage.

- > Read and follow the instructions.
- > Keep this document and pass it on to subsequent users.

We reserve the right to make technical improvements and visual changes to the products illustrated.

2.2 Intended use

SensoWash® is a shower toilet with a spray device for Rearwash and Ladywash cleaning. The product may only be used indoors. Duravit assumes NO liability for any use beyond the intended use or other types of use.

2.3 User requirements

This product may be used by children aged 3 years and over or by persons with reduced physical, sensory or mental capabilities or a lack of experience and/or knowledge if they are supervised or instructed in the safe use of the product and understand the dangers involved.

- > Children may NOT play with the product.
- > Cleaning and maintenance must NOT be performed by children without supervision.

2.4 Electrical safety

Risk of fatal injury caused by electric shock

Contact with electricity can lead to a fatal electric shock.

General precautions

- > The product must be earthed. Do not operate the product without proper grounding. Observe the mounting instructions.
- > The product itself does not have an electrical leakage protection function, it must be installed in a power circuit where a leakage protection device is installed.
- > Means for disconnection must be incorporated in the fixed wiring in accordance with the wiring rules and having a contact separation in all poles that provide full disconnection under overvoltage category III conditions.

Avoid damage to the power cable

If the power supply cable on this product is damaged, it must be replaced by the manufacturer, the customer service agent or similarly qualified persons in order to avoid a hazard.

- > Ensure that the power cable is NOT damaged.
- > The power cable must NOT become jammed or pinched.
- > Keep the power cable away from hot surfaces and sharp edges.

Do NOT use a damaged product

Do NOT use the product if the product does not function properly or is damaged.

- > Switch off the product.
- > Disconnect the power supply.
- > Close the stop valve to interrupt the water supply.
- > Contact help@duravit.com.

Do NOT repair the product yourself

Repairs must only be carried out by persons with the necessary expertise and qualification.

- > Do NOT make modifications, tamper with, install additional equipment or attempt to repair the product.
- > Only use accessories recommended by Duravit.

Avoid short circuit caused by moisture

- > Do NOT install the product in a room exposed to excessive moisture. Ensure sufficient ventilation to avoid condensation in electric components.
- > When the product is brought from a cold location to a warm one, leave the unit switched off for a few hours to avoid condensation.

2.5 Hygiene

Damage to health caused by dirty, polluted or long standing water

Operating the shower functions with dirty, polluted or long standing water can cause damage to health.

- > Supply the product with cold drinking water from the main water system.
- > Do NOT connect any waste water, grey water, industrial water, sea water or other untreated or semi-treated water.
- > Only use the water supply hoses provided with the product. Do NOT reuse old hoses.
- > If the product is NOT to be used for two weeks or more, empty the product and switch it off (holiday mode).

2.6 Information on the use of the remote control with storage battery

Health damage caused by exploding batteries*

The remote control has a built-in battery that cannot be removed. The battery may explode if it overheats and cause fires and other hazards.

- > Only use the charging cable provided with the product.
- > If the battery is damaged, contact help@duravit.com.
- > Do NOT attempt to replace the battery yourself. Do NOT disassemble, drop, squeeze or modify the battery. Do NOT insert or puncture the battery.

- > Do NOT operate the remote control around hot devices such as heaters, microwave ovens, water heaters or ovens.
- > Do NOT expose the remote control to direct sunlight.
- > Do NOT throw the remote control into fire.
- > Do NOT immerse the remote control in water or other liquid.
- > Do NOT treat the remote control/battery as household garbage. Dispose of the remote control/battery according to local regulations.

*Only Pro variant

2.7 Information on the use of batteries

The batteries are located in the remote control.

Risk of fatal injury if swallowed/chemical burn hazard

This product contains coin/button cell batteries. Do NOT ingest battery! If the cell battery is swallowed, it can cause severe internal burns in just 2 hours and can lead to death.

- > Do NOT ingest battery, Chemical Burn Hazard.
- > Keep new and used batteries away from children. If the battery compartment does NOT close securely, stop using the product and keep it away from children.
- > If you think batteries might have been swallowed or placed inside any part of the body, seek immediate medical attention.

Damage to health caused by leaking battery acid

- > Avoid contact with the skin, eyes and mucous membranes if battery acid has leaked.
- > In case of contact with the acid, flush the affected areas with large amounts of clean water and seek medical advice immediately.
- > Do NOT expose the batteries to extreme conditions: Do NOT place them on hot surfaces NOR expose them to direct sunlight. Otherwise there is a risk of leakage.

- > The batteries must be disposed of properly and kept away from children. Even used batteries can cause injury.

2.8 Minor burns

Damage to health caused by minor burns

Prolonged exposure to the seat heating may cause minor burns.

- > Deactivate the seat heating during prolonged use of the toilet, particularly for persons with reduced physical or sensory capabilities.

2.9 Avoid product damage

Information on the use of batteries

- > The batteries must NOT be charged, reactivated by other means, disassembled or subjected to excessive heat (e.g. fire).
- > The pole terminals must NOT be short-circuited.
- > Always remove empty batteries from the remote control immediately. They may leak and cause damage.
- > Do NOT insert new and old batteries together in the remote control.
- > Different types of batteries must NOT be combined.
- > Clean the battery and contacts before inserting the battery.
- > The batteries must be inserted according to the marking with the correct polarity.
- > Remove the batteries when the remote control is NOT used for an extended period of time.

Product damage or malfunctions as a result of improper use

- > Do NOT step on or stand on the product.
- > Do NOT intentionally pollute, spray or clog the spray wand.

Avoid damage to the seat and cover

- > Do NOT stand, sit or lean on the cover.
- > Do NOT remove the seat and cover.
- > Do NOT damage the surface of the seat. If the surface of the seat is damaged, contact help@duravit.com.
- > Use the remote control or app to open and close the cover.
- > Do NOT interrupt auto opening or auto closing with manual force.
- > Ensure that the toilet seat is put down and does not interrupt the auto opening or auto closing of the lid.
- > Do NOT place any heavy objects on the cover.

Damage through freezing water

- > Do NOT install and operate the product in rooms where there is a danger of frost. The room temperature must not be less than 4 °C (39 °F).

Damage caused by external influences

- > Do NOT place or lay open fire sources i.e. candles, cigarettes or the like on the product.
- > Do NOT expose the product to direct water or direct sunlight.

3 Product overview

3.1 Structural and functional description

3.1.1 Seat unit

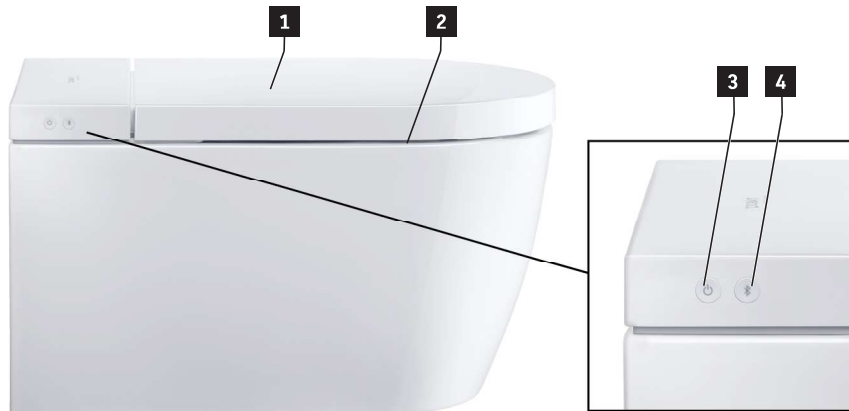

1 Sensor (auto opening lid)*

2 Seat heating

3 Power button/status display (LED)

4 Bluetooth button/Bluetooth display (LED)

*Only Pro variant/Plus variant

3.1.2 LED display on the seat unit

Power button

LED	Function
Red	Standby mode
Green	Switched on
Orange	Energy saving mode
Orange flashing	Descaling is necessary > Descale the product. > Press Power button/status display (LED) once, to deactivate the flashing.
Flashing	Malfunction > Switch off the product. > Disconnect the power supply.

LED	Function
	> Close the stop valve to interrupt the water supply. > Contact help@duravit.com .
Purple flashing	UV-C light is active.*

*Only Pro variant

Bluetooth button

LED	Function
Blue	Bluetooth is available or connected.
Off	Bluetooth is not available.
Flashing	Device is in pairing mode.
Purple flashing	UV-C light is active.*

*Only Pro variant

3.1.3 Functional area Pro

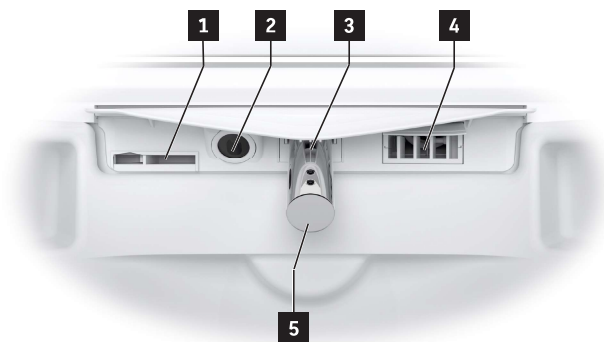

- | | |
|---------------------------------|-------------------------|
| 1 Internal overflow | 4 Warm air dryer |
| 2 UV-C light/Night light | 5 Spray nozzle |
| 3 Spray wand | |

3.1.4 Functional area Plus/Lite

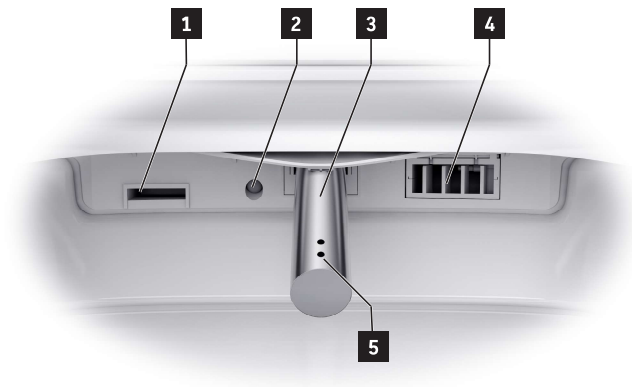

- 1** Internal overflow
- 2** Night light
- 3** Spray wand

- 4** Warm air dryer
- 5** Spray nozzle

3.1.5 Seat sensor and opening descaling agent



- 1** Opening descaling agent

- 2** Seat sensor

3.2 Factory settings

Function	Setting range	Factory setting
Auto opening/Auto closing cover*	on/off	off
Comfortwash	on/off	on
Warm air dryer temperature	off/low/medium/high	medium
Spray wand position	1, 2, 3, 4, 5	3
Water spray intensity	low/medium/high	medium
Water temperature	off/low/medium/high	medium
Seat heating	on/off	on
Seat heating temperature	low/medium/high	medium
Hygiene UV**	on/off	off
Energy saving mode	on/off	off
Night light	off/auto/on	auto
Confirmation tone	on/off	on

*Only Pro variant/Plus variant

**Only Pro variant

4 Initial operation

4.1 Activate the remote control

4.1.1 Remote control with storage battery

CAUTION

Health damage caused by exploding batteries

- > The rated parameters of remote control are: 5VDC 150 mA.
- > The output current of the power adapter shall NOT be greater than 2 A.
- > Only use the charging cable provided with the product.
- > Fully charge the remote control regularly.
- > Always remove the power adapter from the power socket when the charging is completed (LED off).

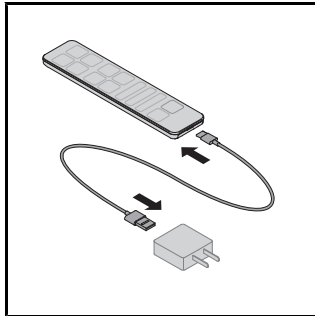

- > Connect the charging cable to the power adapter to the remote control.
- > The LED on the remote control indicates charging mode (LED red).

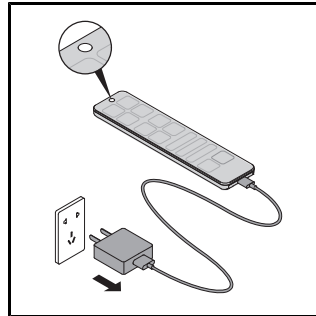

- > Always remove the power adapter from the power socket when the charging is completed (LED off).

4.1.2 Remote control with batteries

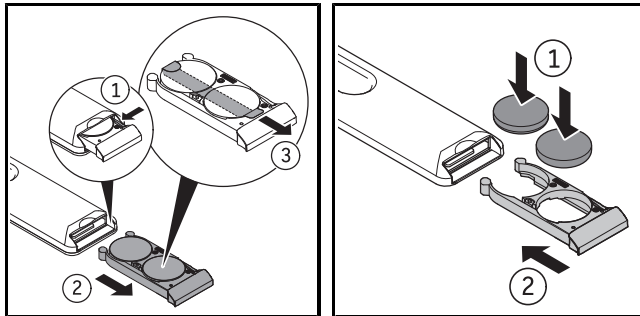

- > Pull out the battery compartment.
- > Press the lever to fully open the battery compartment.
- > Remove the protective film.
- > Insert the batteries (CR2450).
- > Close the battery compartment.

4.2 Switch product on



Damage to health caused by dirty, polluted or long standing water

Operating the shower functions with dirty, polluted or long standing water can cause damage to health.

- > If the product has NOT been used for two weeks or more, activate the additional self-cleaning.

The product must be completely installed and connected to the main power supply and water supply in accordance with the mounting instructions.

- > Ensure that the stop valve is open.
- > Switch on the product via the power button/status display (LED).

The LED lights up green. If necessary, the seat unit performs a self-inspection procedure that can take several minutes.

- > In order to test the product, place the splash guard between the ceramic and the seat.
- > Press and hold the seat sensor until a confirmation tone sounds.
- > Activate the function Rearwash or Ladywash to test the product.

4.3 Download the app



- > Search for "SensoWash 2.0" in the Play Store (Android) or for "SensoWash" in the App Store (iOS).
- > If necessary, agree to access the location services (GPS).
- > Download the app.

4.4 Connect the app

The product connects to the app via Bluetooth. Power and bluetooth have to be activated to establish the connection.

- > Activate the product via the power button/status display (LED) on the seat unit.

The button starts to flash.

- > Activate Bluetooth via the Bluetooth button/Bluetooth display (LED) on the seat unit.
- > Activate the app on the mobile device.
- > Follow the step-by-step instructions in the app.

The app confirms when the connection is established.

4.5 Pairing remote control with shower toilet

Activate the pairing mode with the remote control if the LED on the top of the remote control flashes red.

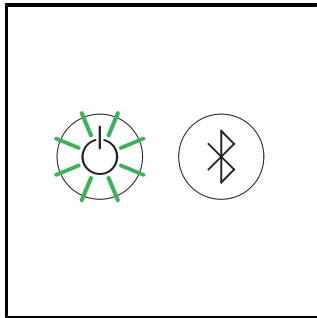

> Ensure that the product is activated (power button/status display (LED) lights up green).

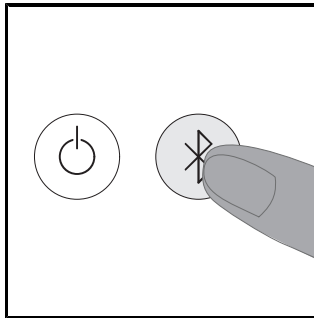

> Press the Bluetooth button/Bluetooth display (LED) on the product for several seconds.

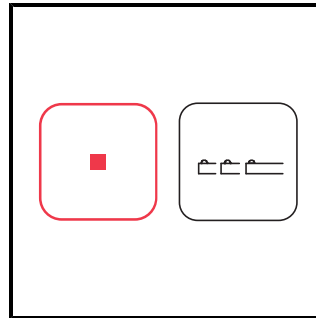

> Press and hold the stop button on the remote control.

> First press the left arrow, then press the right arrow on the button spray wand position.

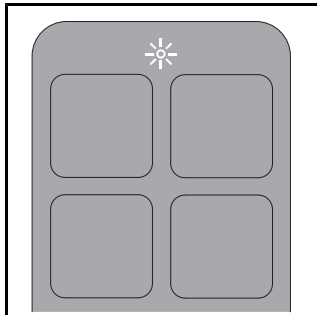

The LED on the top of the remote control lights up white for several seconds when the connection is established.

4.6 Pairing remote control with electronic actuator plate*

Activate the pairing mode with the remote control if the display on the electronic actuator plate flashes.

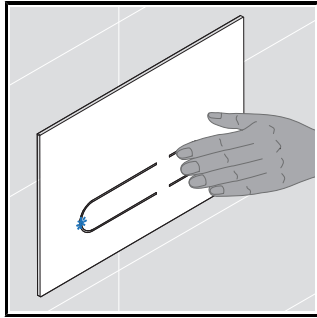

> Press the display of the electronic actuator plate until the LED on the top of the remote control flashes blue.

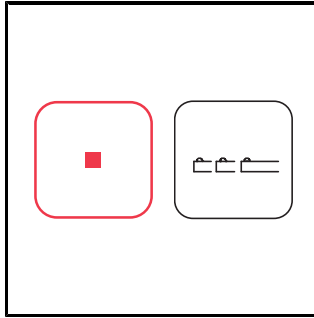

> Press and hold the stop button on the remote control.
> First press the left arrow, then press the right arrow on the button spray wand position.

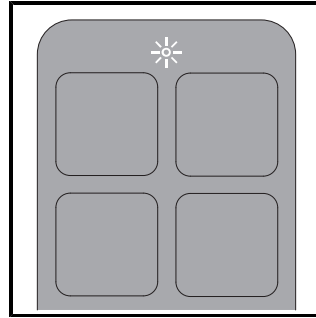

The LED on the top of the remote control lights up white for several seconds when the connection is established.









*Only Pro variant. Only in combination with Duravit installation frame and electronic actuator plate.





5 Operation

5.1 Remote control/App

The product can be controlled by remote control (basic setting range) and/or by app (extended setting range). A number of settings can only be made via the app. The functions are configured according to the factory settings.

> Download the app to complete the full range of settings available for this product.

Symbol	Name
	Menu
	Add/delete device.
	Activates the full flush . Only in combination with Duravit installation frame and electronic actuator plate.
	Activates the Eco flush . Only in combination with Duravit installation frame and electronic actuator plate.
	Activates Rearwash . If the function is not stopped, it automatically ends after 2 minutes.
	Activates Ladywash . If the function is not stopped, it automatically ends after 2 minutes.
	Activates Warm Air Dryer . The function temperature can be set to the levels off, low, medium, high. The function level can be set to the levels low/high.** If the function is not stopped, it automatically ends after 5 minutes. [►App] Home – Warm air dryer
	Adjusts Water Temperature . The function can be set to the levels off, low, medium, high. The settings are indicated on the remote control (LED) and in the app. [►App] Home – Rearwash/Ladywash

Symbol	Name
	Adjusts Water Spray Intensity . The function can be set to the levels low, medium, high. The settings are indicated on the remote control (LED) and in the app. [►App] Home – Rearwash/Ladywash
	Adjusts Spray Wand Position . The function can be set to the levels 1, 2, 3, 4 and 5. The settings are indicated on the remote control (LED) and in the app. [►App] Home – Rearwash/Ladywash
	Activates the Odour extraction . Only in combination with Duravit installation frame and electronic actuator plate.
<div>1</div> <div>2</div> <div>3</div> <div>4</div>	Activates User Profile (remote control only).
	Opens/closes the cover .*
	Stops the running function.

*Only Pro variant / Plus variant

**Only Pro variant

TIP The seat has a sensor. Shower and drying functions can only be activated when a user is sitting on the toilet.

5.2 Open and close the cover

NOTE

Damage to the seat unit

Interrupting the current mechanical opening and closing of the cover can cause damage to the product.

- > Do NOT interrupt the mechanical opening and closing of the cover with manual force.

The cover can be opened and closed by remote control or the app. The Pro and Plus variant also has a proximity sensor. The cover opens and closes without contact as soon as a user approaches or moves away.

5.3 Set the user profile by remote control

Personal preferences can be stored in various user profiles.

- > Activate the Rearwash/Ladywash.
- > Set the spray wand position, water spray intensity and water temperature while the function is active.

The LEDs on the remote control indicate the settings.

- > Press the user profile 1/2/3/4 for 3 seconds to save the profile.

TIP The seat has a sensor. Shower and drying functions can only be activated when a user is sitting on the toilet.

5.4 Energy and water efficiency

To minimise the consumption of natural resources, the product has an instant heating system and an auto-stop function for all shower and drying functions. The following settings can be adjusted to save energy in daily use:

5.4.1 Energy saving mode (seat heating)

Deactivates the seat heating for a specified period of time, e. g. during daytime, while at work. The seat heating is then reactivated.

- > Activate energy saving mode via the app. [►App] Menu – Settings – Seat

5.4.2 Holiday mode

If the product is not to be used for two weeks or more, empty the product and switch it off.

- > Close the stop valve to interrupt the water supply.
- > Activate holiday mode via the app. [►App] Menu – Care – Holiday mode

The water tank is drained. The app confirms when the procedure is completed.

- > Disconnect the power supply.
- > Remove the batteries from the remote control.

6 Cleaning and care

6.1 Safety



WARNING

Risk of fatal injury caused by electric shock

The seat unit contains the electrical components of the product.

- > Disconnect the product from the main power supply before cleaning.
- > Do NOT pour water over the seat unit.
- > Do NOT allow water to get into the seat unit.



CAUTION

Health damage caused by ultraviolet light (UV-C)*

The product contains a UV-C light source that disinfects the ceramic. The UV-C light is only active when seat and lid are closed. Looking into or touching the UV-C light source while the function is active can cause eye damage or skin damage.

- > If the UV-C light is active when seat and lid are open (status display (LED) and bluetooth display (LED) flash purple), close seat and lid immediately and contact Duravit.
- > Do NOT look directly at the UV-C light source.
- > Do NOT touch the UV-C light source.

*Only Pro variant

NOTE

Product damage due to incorrect cleaning and care

Incorrect cleaning agents, cleaning tools and cleaning equipment can damage the surface and permanently discolour it.

- > Only use cleaning agents and cleaning tools recommended by Duravit.
- > Follow the cleaning agent manufacturer's instructions for use.
- > Only use cleaning equipment that is intended for the application (NO high-pressure washers or steam cleaning machines).

NOTE

Product damaged caused by spray mist

Spray can penetrate into very small openings and gaps and damage the surface.

- > Spray the spray cleaner onto the cleaning cloth and not directly onto the product.

NOTE

Product damage caused by long cleaning intervals

If the cleaning is not carried out regularly enough, soiling may become more difficult to remove.

- > Regularly clean the surface and clean immediately if soiled.

6.2 Cleaning recommendations

6.2.1 Cleaning

- > Clean the surface with a damp cleaning cloth.
- > Remove heavier soiling with the recommended cleaning agent. Always apply the cleaning agent to the cleaning cloth.
- > Use a toilet brush to clean the toilet/urinal bowl.
- > Rinse with clean water to remove all traces of the cleaning agent.
- > Dry the surface.

6.2.2 Recommended cleaning agents

Component	Cleaning agent	Cleaning tools
Seat and cover	Neutral cleaning agent (pH 6 – 8) (e.g. neutral cleaner)	Cotton cleaning cloth
Cover	Neutral cleaning agent (pH 6 – 8) (e.g. neutral cleaner)	Cotton cleaning cloth
Spray wand/spray nozzle	Neutral cleaning agent (pH 6 – 8) (e.g. neutral cleaner)	– Microfibre cleaning cloth – Abrasive sponge
Ceramic Daily cleaning	Neutral cleaning agent (pH 6 – 8) (e.g. neutral cleaner)	– Microfibre cleaning cloth – Toilet brush
Ceramic Limescale	Acidic cleaning agent (pH < 6) (e.g. lemon-based cleaner)	– Microfibre cleaning cloth – Toilet brush
UV-C light source*	Water	Cotton cleaning cloth
Remote control	Water	Cotton cleaning cloth

*Only Pro variant

6.3 Self-cleaning of spray wand and spray nozzle

The retracted spray wand is automatically cleaned before and after each washing process.

- > If the product has NOT been used for two weeks or more, activate the additional self-cleaning via the app. [►App] Menu – Care – Self-cleaning

6.4 Manual cleaning mode for the spray wand and spray nozzle

Manual cleaning is only possible if the seat sensor is not activated.

- > Activate the manual cleaning mode via the app to extend the shower rod for manual cleaning. [►App] Menu – Care – Manual cleaning

TIP The function can only be activated if nobody is sitting on the toilet/the seat sensor is not activated.

6.5 Descaling

NOTE

Functional restrictions or product damage due to limescale build-up

Limescale can build-up in regions with hard water. Limescale can impair the performance of the product.

- > Check the water quality in the region. Duravit recommends the installation of a water softener with water hardness ≥ 14 °dH (2.5 mmol/l).
- > Descale the product regularly. The app sends an automatic reminder.
- > Configure the descaling settings according to the regional water hardness.
[►App] Menu – Care – Descaling
- > Only use original descaling agents from Duravit or those approved by Duravit.
- > Go to www.duravit.com, enter "Descaling" in the search field and choose descaling tablets or descaling cartridge according to model.

Water hardness	Descaling cycle
soft: <8.4 °dH (1.5 mmol/l)	every six months
medium: $8.4 - 14$ °dH (1.5 – 2.5 mmol/l)	every six months
hard: >14 °dH (2.5 mmol/l)	quarterly

The descaling process can be activated via the app.

- > Follow the instructions in the app.

The descaling process can be activated via the remote control.

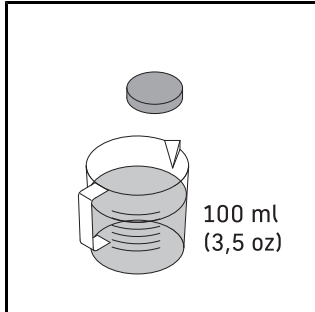

- > Dissolve the descaling agent in 100 ml (3.5 oz) of warm water.
- > Wait until the descaling agent is dissolved completely.
- > Follow the instructions provided by the manufacturer.

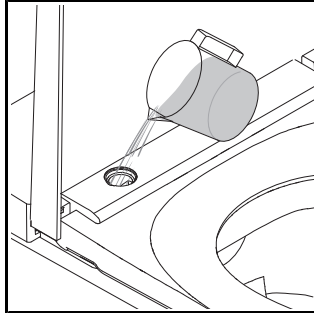

- > Deactivate the function Auto opening/Auto closing cover prior to descaling.
- > Remove the cover.
- > Pour the descaling agent into the opening.

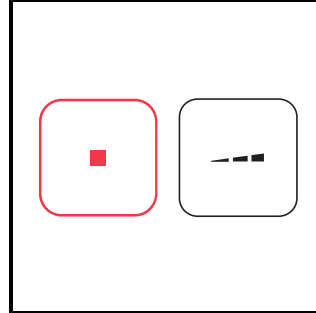

- > Press and hold the stop button.
- > Press and hold water spray intensity - on the remote control until a confirmation tone sounds.
- > Release the buttons.

The descaling process starts. The descaling process takes approx. 1/2 h. During this time the product cannot be used.

7 Troubleshooting support

7.1 General information

How to proceed in the event of a fault:

- > Switch the product off and then on again.
- > Follow the instructions below.
- > If the product still does not work properly, contact help@duravit.com.
- > Have the article number at hand. The article number can be found in the Technical Data at the end of the user manual, on the packaging label, on the product label and in the app.
[►App] Menu – Device guide – Device management – Device information

7.2 Troubleshooting

Problem	Potential cause	Solution
LED display (seat unit)		
The LED display flashes (red, green) or a beep sounds.	Malfunction	<ul style="list-style-type: none">> Switch off the product.> Disconnect the power supply.> Close the stop valve to interrupt the water supply.> Contact help@duravit.com.
The LED display flashes orange.	Descaling is necessary.	<ul style="list-style-type: none">> Descale the product.> Press Power button/ status display (LED) once, to deactivate the flashing.
General problems		
Product does not work.	The product is in standby mode (power button/ status display lights up red).	<ul style="list-style-type: none">> Activate the product.
Water is leaking out.	Leakage	<ul style="list-style-type: none">> Switch off the product.> Disconnect the power supply.

Problem	Potential cause	Solution
		<ul style="list-style-type: none"> > Close the stop valve to interrupt the water supply. > Contact help@duravit.com.
Remote control		
The remote control does not respond.	The batteries are almost flat (LED display flashes white).	> Replace the batteries or charge the remote control.
	The remote control is not connected to the product (LED on the top of the remote control flashes red).	> Activate the pairing mode for the remote control.
	No batteries are inserted.***	> Insert the batteries.
	The remote control is defective.	> Contact help@duravit.com .
Shower functions		
Switching between the Rearwash and Ladywash takes too long.	The spray wand retracts between the functions. Switching takes approx. 12 seconds.	Normal condition
The water spray intensity is too weak.	The water spray intensity is set to "low".	> Increase the water spray intensity. [►App] Home – Rearwash/Ladywash
	The water pipe is bent or crushed.	> Contact help@duravit.com .
The water temperature is too high/low.	The temperature is set incorrectly.	> Set the temperature. [►App] Home – Rearwash/Ladywash
The Rearwash/Ladywash stops automatically.	The function stops automatically after 2 minutes.	Normal condition

Problem	Potential cause	Solution
	The seat sensor has lost contact.	<ul style="list-style-type: none"> > Sit down again. > Activate the function.
The Rearwash/Ladywash does not work.	The spray nozzle is blocked.	<ul style="list-style-type: none"> > Clean the spray nozzle. [►App] Home – Rearwash/Ladywash
	The seat sensor has lost contact.	<ul style="list-style-type: none"> > Sit down again. > Activate the function.
Seat heating		
The seat heating does not work.	The function is deactivated.	<ul style="list-style-type: none"> > Activate the function. [►App] Settings – Seat
The seat temperature is too high/low.	The temperature is set incorrectly.	<ul style="list-style-type: none"> > Set the temperature. [►App] Settings – Seat
The seat temperature is too low.	The product is in energy saving mode (LED display lights up orange).	<ul style="list-style-type: none"> > Deactivate energy saving mode. [►App] Settings – Seat
	The product automatically activate energy saving mode if all functions have been inactive for more than 48 hours.	<ul style="list-style-type: none"> > Select any function to reactivate the product.
Warm air dryer		
The warm air dryer temperature is too high/low.	The temperature is set incorrectly.	<ul style="list-style-type: none"> > Set the temperature. [►App] Home – Warm air dryer
The warm air dryer stops automatically.	The function stops automatically after 5 minutes.	Normal condition
	The seat sensor has lost contact.	<ul style="list-style-type: none"> > Sit down again. > Activate the function.

Problem	Potential cause	Solution
Night light		
The night light does not work.	The function is deactivated.	> Activate the night light or auto mode. [►App] Settings – Light and sound
	Auto mode is activated. The function automatically deactivates the night light when the ambient light is bright.	Normal condition
The night light lights up continuously.	The function is activated.	> Deactivate the night light or activate auto mode. [►App] Settings – Light and sound
	Auto mode is activated. The function automatically activates the night light when the ambient light is too dark.	Normal condition
Manual cleaning		
The spray wand retracts automatically.	The function stops automatically after 2 minutes.	> Activate the function. [►App] Care – Manual cleaning
Automatic self-cleaning		
Water is dripping out of the retracted spray wand.	The retracted spray wand is automatically cleaned before and after each washing process.	Normal condition
Lid*		
The cover does not open automatically.	The product has not detected the approaching user.	> Approach the product again (distance approx. 1 m).
	The function is defective.	> Contact help@duravit.com .

Problem	Potential cause	Solution
	The function is not activated.	> Activate the function. [►App] Settings – Cover
The cover does not close immediately.	After the user has moved away, the cover closes automatically after 90 seconds.	Normal condition
App		
The app does not work.	The app and product are not connected.	> Connect the product to the app. > Ensure that the connection is successful.
UV-C light**		
The UV-C light does not work.	The function is deactivated.	> Activate the function. [►App] Settings – UV-C light
	The product automatically deactivates the UV-C light when seat and lid are opened.	> Keep the lid closed while the function is running (LEDs are flashing purple).

*Only Pro variant / Plus variant

**Only Pro variant

***Only Plus variant / Lite variant

8 Disposal

8.1 Packaging

Children must not play with plastic bags and packaging material, due to possible injury or danger of suffocation. Store such material safely or dispose of it in an environmentally-friendly manner. If possible, keep the packaging until the warranty period expires.

8.2 WEEE



■ The crossed-out wheeled bin logo requires the separate collection of waste electric and electronic equipment (WEEE). Electric and electronic equipment may contain dangerous and hazardous substances. Do not dispose of this appliance as unsorted municipal waste. Return it to a designated collection point for the recycling of WEEE. By doing so, you will help to conserve resources and protect the environment. Contact your retailer or local authorities for more information. Used batteries must be disposed of properly. For this purpose, appropriately labelled containers for disposal of batteries are provided in shops where batteries are sold and at community collection points.

9 Technical data

General information	
Article number	#650000012004320 #650001012004310 #650002012004300
Net weight	32,5 kg (78,3 lbs)
Dimensions	376 x 578 x 405 mm (15 x 22 7/8 x 16 ")
Integrated safety device	EN13076 - type AA
Rated voltage	220 – 240 V
Frequency	50 – 60 Hz
Rated power	1080 W
Standby power	< 0.5 W
Incoming water pressure	0.07 – 0.75 MPa / 0.7 – 7.5 bar (10 – 109 psi)
Protection class	IPX4 Protection against spray water on all sides
Temperature range	
Operating temperature	4 – 40 °C (39 – 104 °F)
Water temperature	33 – 41 °C (91 – 106 °F)
Seat temperature	30 – 40 °C (86 – 104 °F)
Warm air dryer temperature	35 – 55 °C (95 – 131 °F)
Water consumption	
Water consumption in spray mode	0.35 – 0.7 l/min (0.09 – 0.18 gal/min)
BLE (Bluetooth Low Energy)	
Max. power level	< 10 dBm

Radio Frequency Compliance Statement

The bluetooth and microwave installed inside are in compliance with the essential requirements and other relevant provisions of RED Directive 2014/53/EU.

- Bluetooth Low Energy operating frequency bands: 2.402 – 2.480 GHz; Maximum radiofrequency power transmitted in the frequency bands in which the radio equipment operates is less than 10 mW.
- Microwave operating frequency bands: 24.05 – 24.25 GHz; Maximum radiofrequency power transmitted in the frequency bands in which the radio equipment operates is less than 16 mW.



United Kingdom: Limited implementation

Only 24.050 – 24.250 GHz to protect police speed meter therefore please use only indoor in order to provide sufficient shielding from the police scanners.

France: Limited implementation

Power limited to 0,1 mW e.i.r.p in frequency band 24.10 – 24.15 GHz. Military Radiolocation use. Operation by police forces of radar speed meters therefore please use only indoor in order to provide sufficient shielding.

Warranty

The warranty terms and conditions can be found in the General Terms and Conditions (GTC) at <https://pro.duravit.com/gtc>.