

## Basic set for mixers floor-standing

Finish: Article Number: **10452180**



### product features

- for mounting on unfinished floor
- suitable for single lever bath mixer, single lever basin mixer and bath spout floor-standing
- connection dimension: DN15
- minimum mounting depth: 53 mm
- maximum mounting depth: 133 mm

### Certificates / Sustainability



### Product image



### Scale drawing

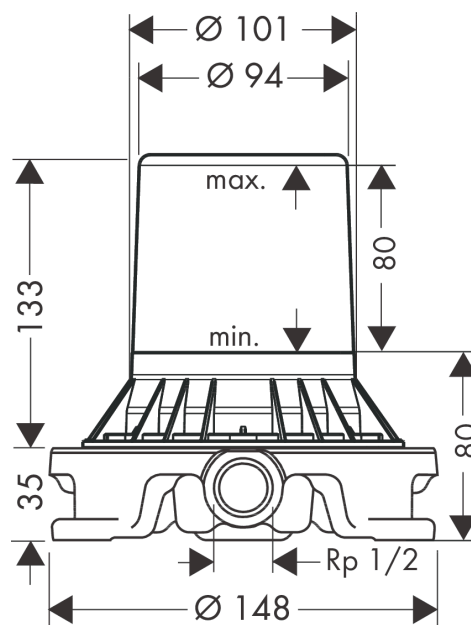

**Basic set for mixers floor-standing**  
 Finish: Article Number: **10452180**



## Exploded Drawing

Year of production: >01/07

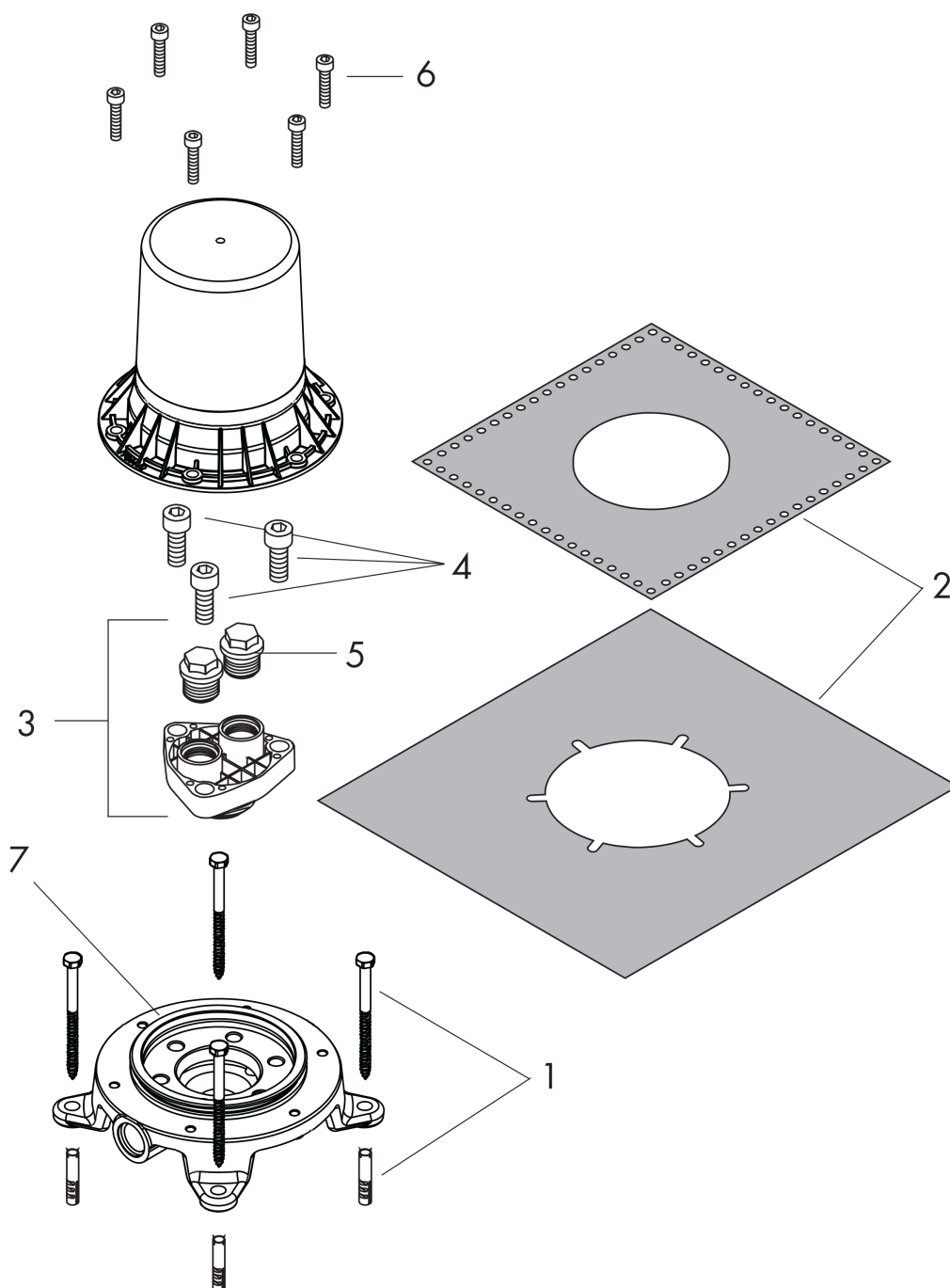

## Basic set for mixers floor-standing

Finish: Article Number: **10452180**



## Spare part list

Year of production: >01/07

Pos.		Article Number	PC	PU
1	mounting kit	96260000	9	1
2	sealing foil	96441000	16	1
3	flushing unit complete	96459000	9	1
4	hexagon socket screw M10x35	97670000	5	1
5	O-ring 15x2,5	98131000	1	1
6	hexagon socket screw M6x16	92857000	1	1
7	O-ring 99x3,5	92154000	3	1