

# LAUFEN PRO S FURNITURE

## Tall cabinet

48312.1

48312.2



### TECHNICAL DATA

Order no.	48312.1 / door hinge left 48312.2 / door hinge right	Mounting acc. incl.	Installation set for furniture, order no. 49260.0, 49260.1
Dimensions (WxHxD)	350 x 1650 x 335 mm	Mounting information	The walls installed on must meet the requirements of the furniture in terms of weight and the supplied fastening elements. If this cannot be guaranteed another method of installation needs to be chosen. For example with feet.
Specification	Body/Front – MDF board with PVC foil Integrated handle in the front 1 door, 4 glass shelves (adjustable)	Colours	463 – White 464 – White glossy 423 – Wenge 479 – Bright oak 480 – Graphite 999 – 38 other lacquered colours
Weight	38,0 kg		
Accessories excl.	Feet (2 pieces), aluminium, height X / order no. 165 mm / 48309.1, 244 mm / 48310.0, 279 mm / 48309.3, 355 mm / 48309.2, 380 mm / 48309.5, 387 mm / 48309.8, 395 mm / 48309.6, 422 mm / 48310.1, 445 mm / 48310.2		

### TECHNICAL DRAWINGS / S 1 : 20

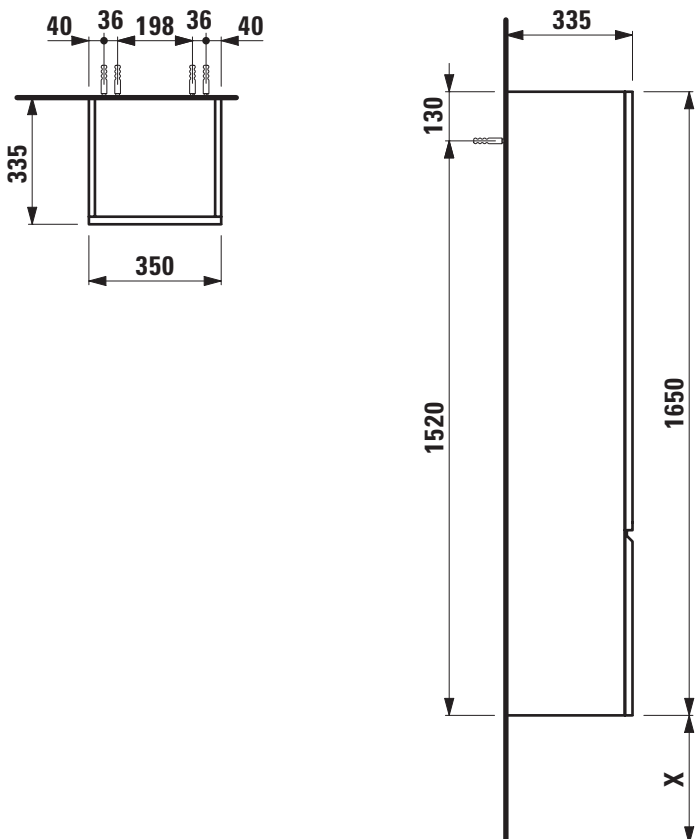

X = The exact height must be set during installation.