



- Deck mounted
- Single lever
- Chrome
- Fixed Spout
- Easy fix
- Double water inlet
- Plastic cartridge with heat and flow limiter
- Flexible hose with stainless steel braiding

Technical Data

Flow properties

Flow-rate at 3 bar **Max 5.0 L/min**

Technical properties

Hot water supply **Max: 80 °C (Recommended: 5-65 °C)**
 Working pressure **0,5-10 Bar (Recommended: 1-5 Bar)**
 Connection size **G 3/8"**
 Body material **Brass**
 Projection **114 mm**
 Spout height **78 mm**

Certificates

DWGV conformity

Regulations

EN standard **EN 817**

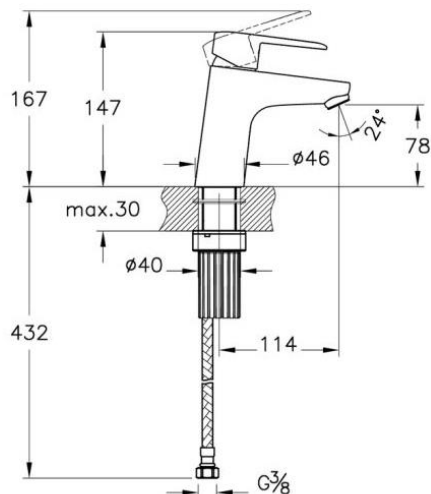

Spare Part List - A42966EXP

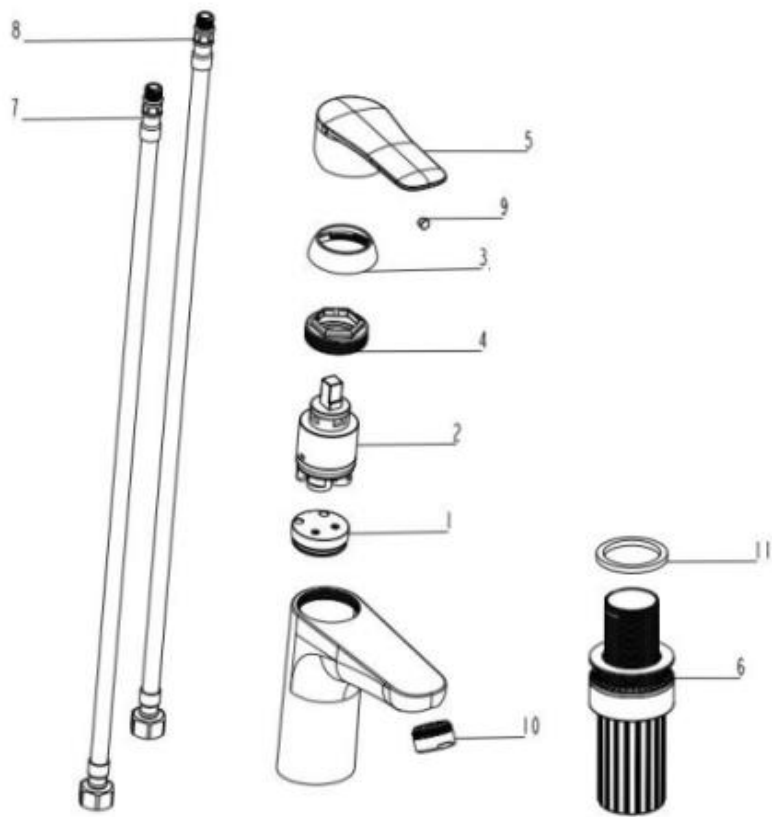

NO	CODE	DESCRIPTION	QUANTITY
1	A33122YP	INNER BODY	1
2	A22874YP	Ø35 CARTRIDGE	1
3	A2461601YP	CARTRIDGE COVER	1
4	A2461740YP	RETAINING NUT	1
5	A3376201VD000RBYP	HANDLE	1
6	A36951YP	FIXING SET	1
7	A3361498YP	M10 3/8" FLEXIBLE HOSE	1
8	A3361496YP	M10 3/8" FLEXIBLE HOSE	1
9	A20697YP	HOLE CAP	1
10	A3318501YP	M24X1 AERATOR	1
11	A24690YP	SEALING	1