



- Deck mounted
- Single lever
- Chrome
- Fixed Spout
- Easy fix
- Double water inlet
- Plastic cartridge with heat and flow limiter
- Flexible hose with stainless steel braiding
- Pop-up controlled
- Waste set included

### Technical Data

#### Flow properties

Flow-rate at 3 bar **Max 5.0 L/min**

#### Technical properties

Hot water supply	<b>Max: 80 °C (Recommended: 5-65 °C)</b>
Working pressure	<b>0,5-10 Bar (Recommended: 1-5 Bar)</b>
Connection size	<b>G 3/8"</b>
Body material	<b>Brass</b>
Projection	<b>114 mm</b>
Spout height	<b>78 mm</b>

#### Certificates

DWGV conformity

#### Regulations

EN standard **EN 817**

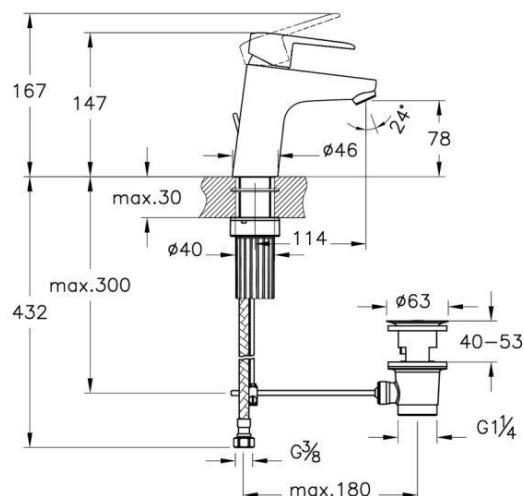

Spare Part List – A42994EXP

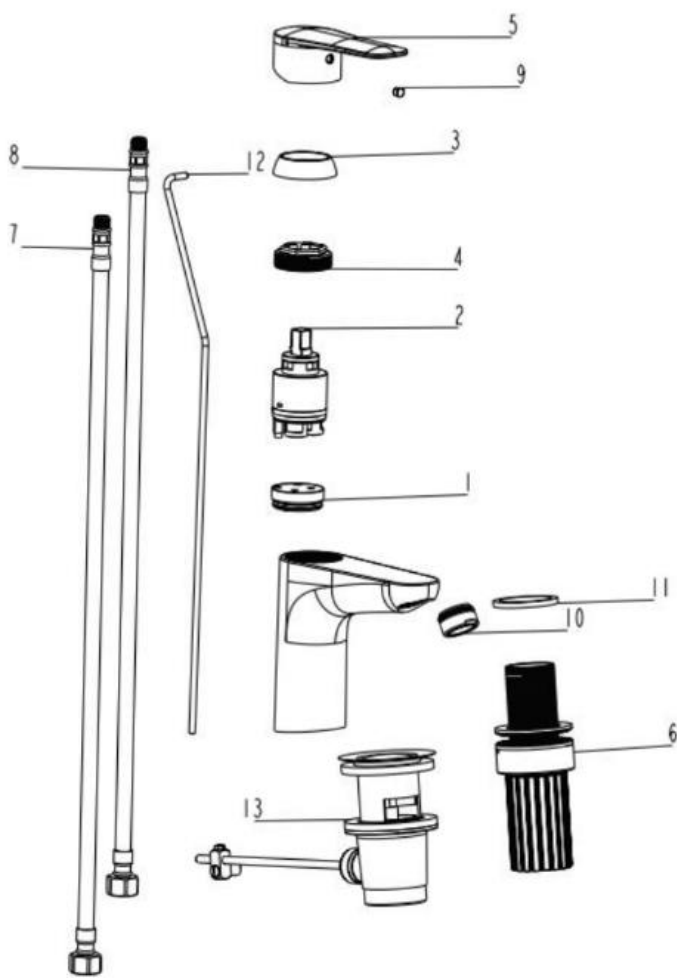

NO	CODE	DESCRIPTION	QUANTITY
1	A33122YP	INNER BODY	1
2	A22874YP	Ø35 CARTRIDGE	1
3	A2461601YP	CARTRIDGE COVER	1
4	A2461740YP	RETAINING NUT	1
5	A3376201VD0YP	HANDLE	1
6	A36951YP	FIXING SET	1
7	A3361498YP	M10 3/8" FLEXIBLE HOSE	1
8	A3361496YP	M10 3/8" FLEXIBLE HOSE	1
9	A20697YP	HOLE CAP	1
10	A3318501YP	M24X1 AERATOR	1
11	A24690YP	SEALING	1
12	A2246901YP	POP-UP ROD	1
13	A3255301YP	SYPHON	1