

Product: KLUDI ZENTA single lever sink mixer DN 10

Ref.: 38973..75

Product description

single lever sink mixer DN 10
solid lever
single hole mounted
flow class A
aerator M 24 x I
ceramic cartridge
swivelling spout (360°)
rapid installation set
flexible high pressure supply tubes G 3/8
noise group I

Finishes:
05 chrome
86 chrome/black
91 chrome/white
96 stainless steel look

Product picture



Advertisement

- * KLUDI GmbH & Co KG KLUDI ZENTA single lever sink mixer
item no. 38973..75
- ** ceramic cartridge Ø 25 mm , DIN EN 817
- *** chrome plated brass, DIN 50930-6

single lever sink mixer, manufacturer KLUDI GmbH & Co KG KLUDI ZENTA single lever sink mixer item no. 38973..75, DN 10, finishes: 05 = chrome plated / 86 = chrome/black / 91 = chrome/white plated brass 96 = stainless steel look, type: single lever sink mixer DN 10, swivel spout, solid lever, lever projection 89 mm, aerator M 24 x I, noise level DIN 4109 group I, report no. P- IX., flow class A (max. 0,15 l/s), nozzle projection 195/211 mm, rapid installation set, flexible high pressure supply tubes 3/8 inch with metal body with DVGW / KIWA / WRAS / CSTB length 350 mm, nozzle height 155/180 mm, overall length 228 mm, ceramic cartridge Ø 25 mm, for borehole diameter Ø 34 mm, for pressure type water heater, for continuous line heater, PN 10,

Dimensional drawing

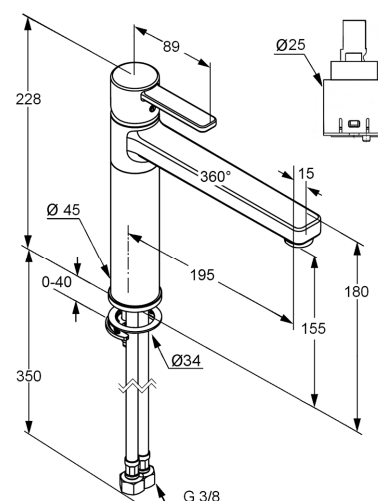

Flow rate diagram

