



# HANSATWIST

Installation and maintenance guide

**0906 3283 , 0906 3285**

I (ISO 3822)

EN 817

100 - 1000 kPa

0.15 l/s (300 kPa)

0.10 l/s (300 kPa w/Controller)

200 kPa (0.1 l/s)

max. +80°C

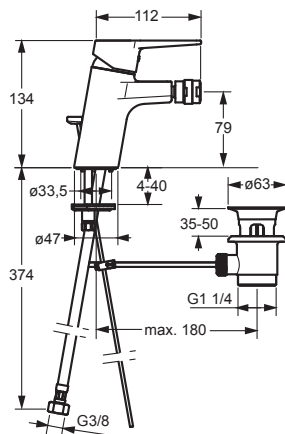

mpi.hansa.com/09063283

**0909 2183 , 0909 2185**

I(ISO3822)

EN 817

50 - 1000 kPa

0.1 l/s (300 kPa w/Controller)

max. +90°C

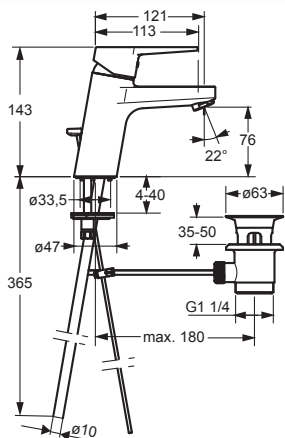

[mpi.hansa.com/09092183](http://mpi.hansa.com/09092183)

**0909 2283 , 0909 2285**

EN 817

100 - 1000 kPa

0.20 l/s (300 kPa)

300 kPa (0.2 l/s)

max. +90°C

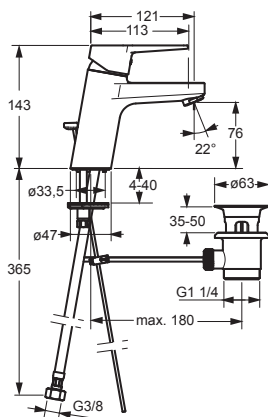

[mpi.hansa.com/09092283](http://mpi.hansa.com/09092283)

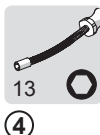
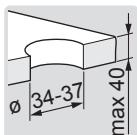
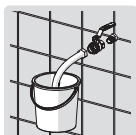

max.  
1600 kPa

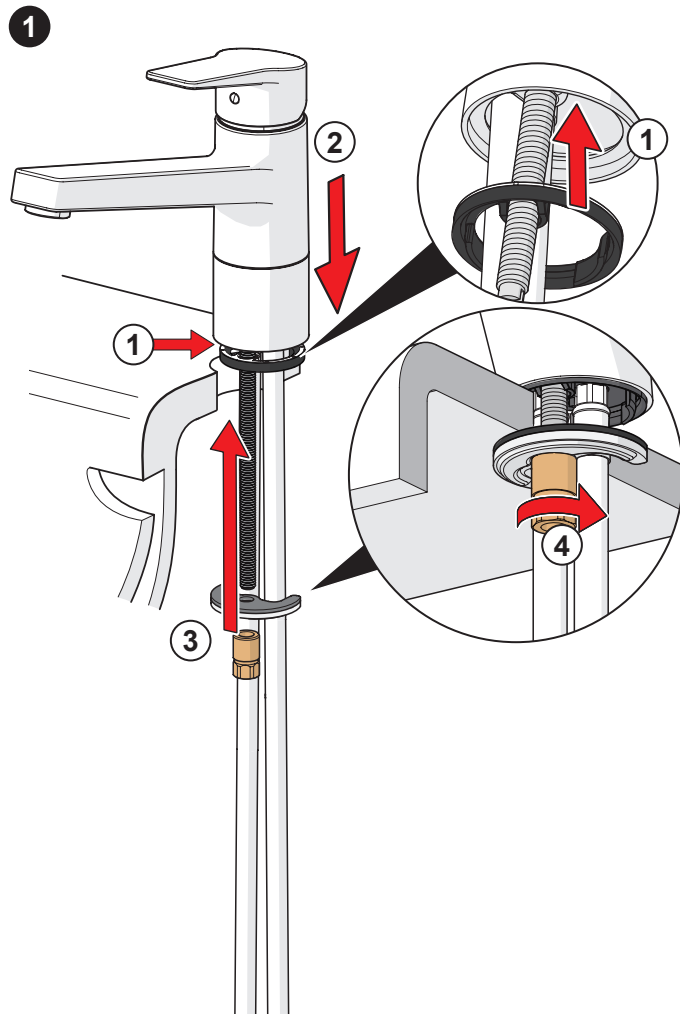
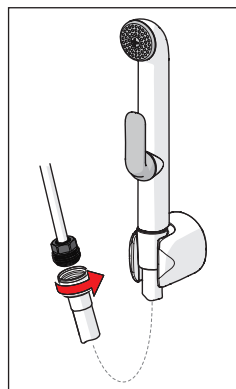
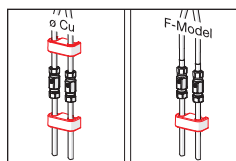
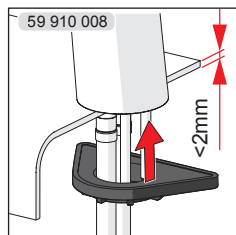

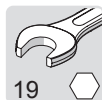

①

②

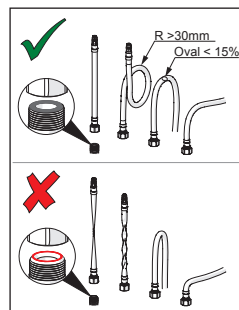
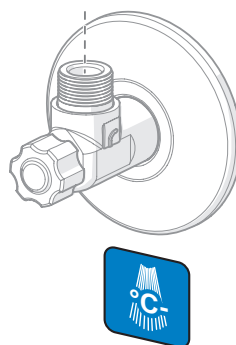
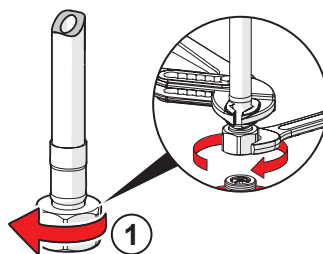
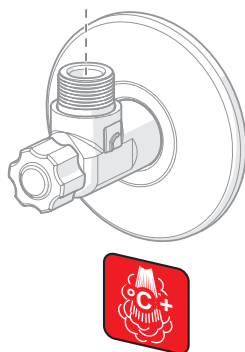
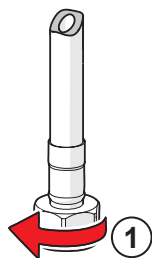

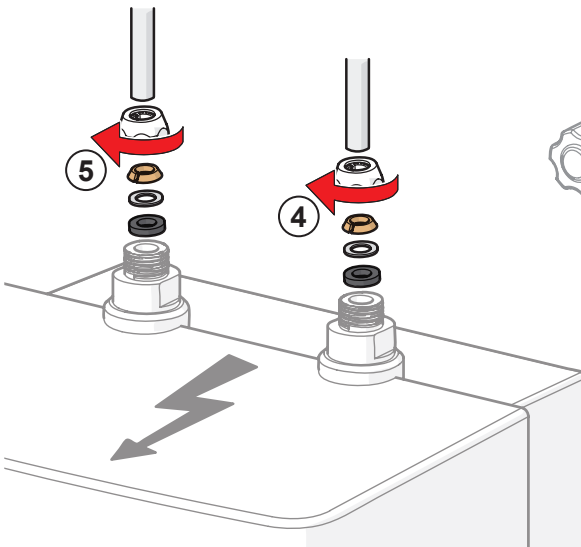
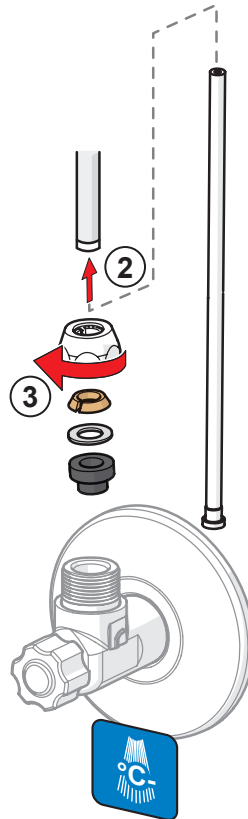
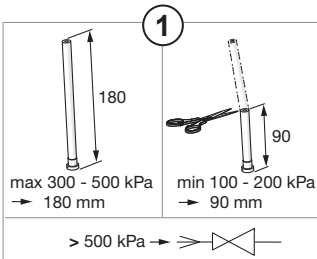
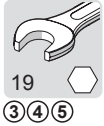

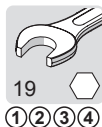

**B**

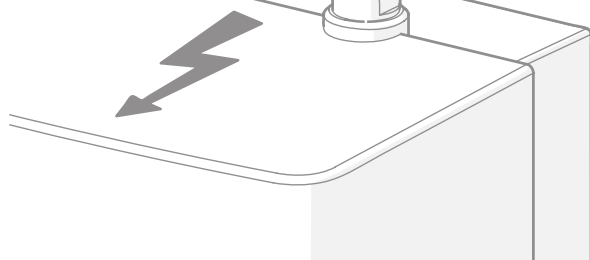
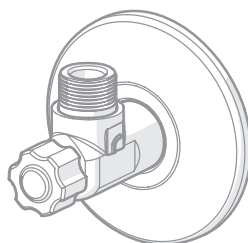
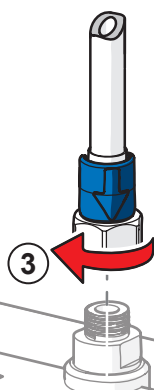
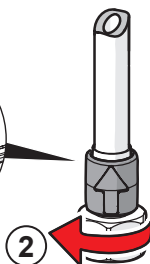
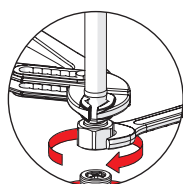
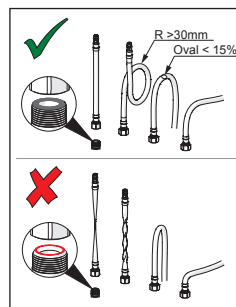

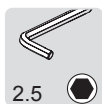
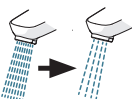
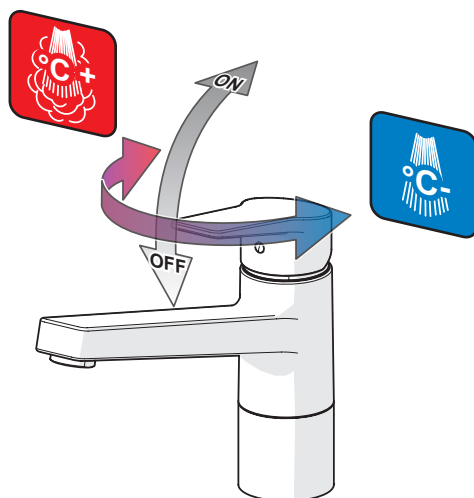

② ⑥

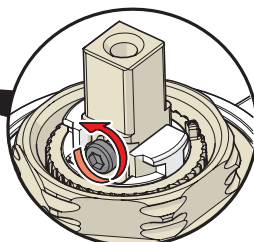
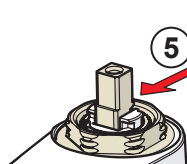
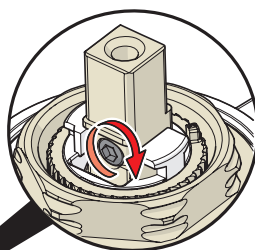
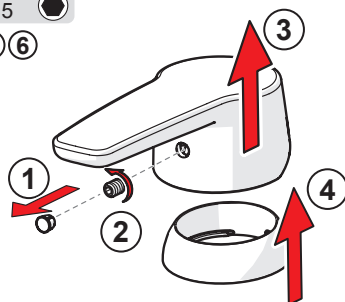



②



A

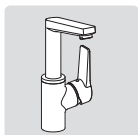

A



A



A



B

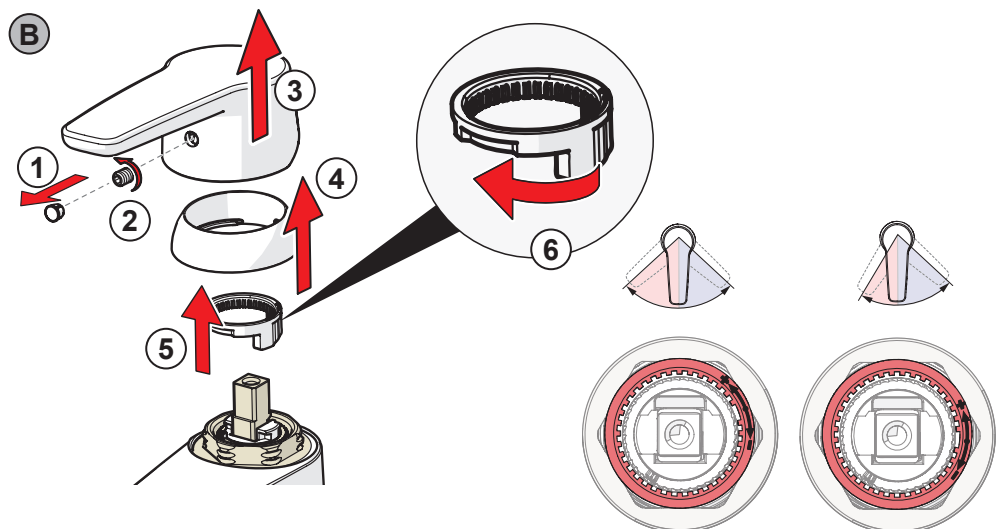
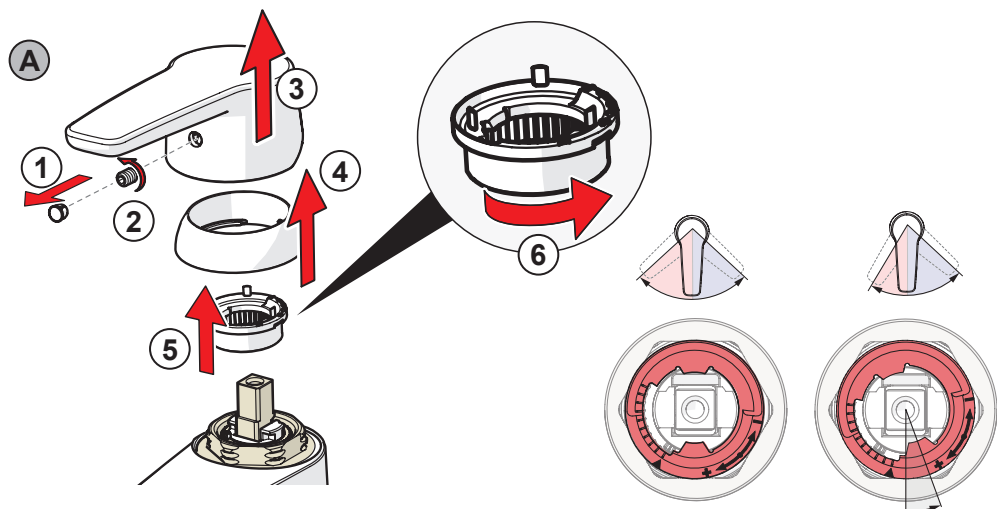



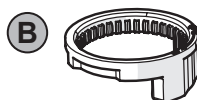
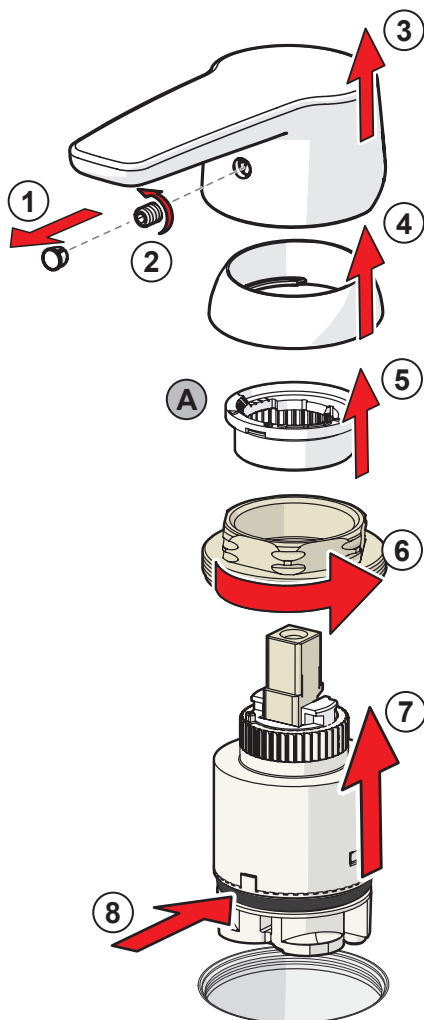
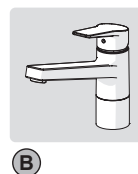
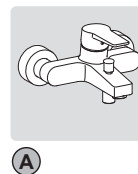
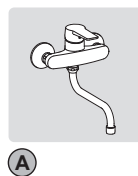
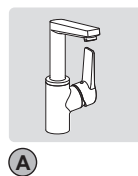
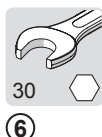
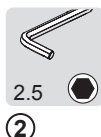

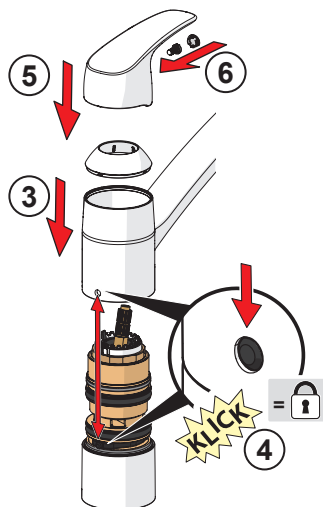
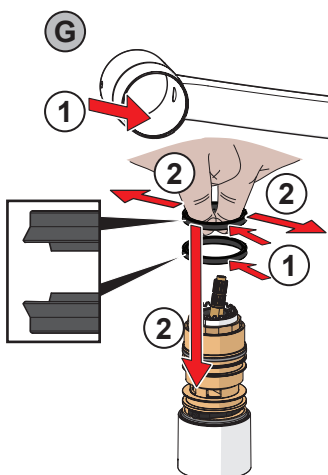
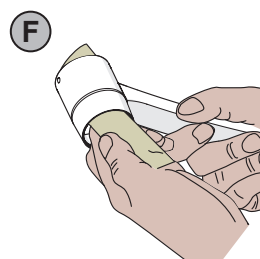
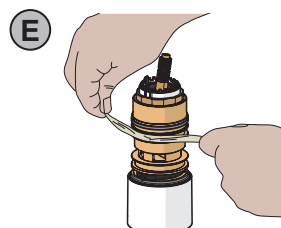
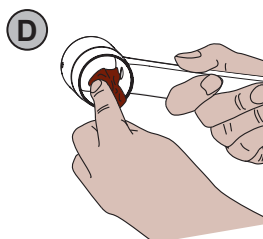
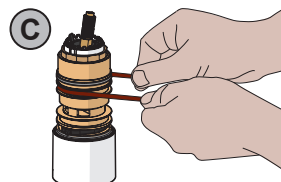
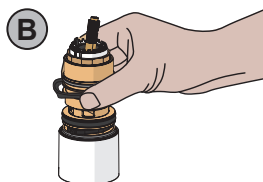
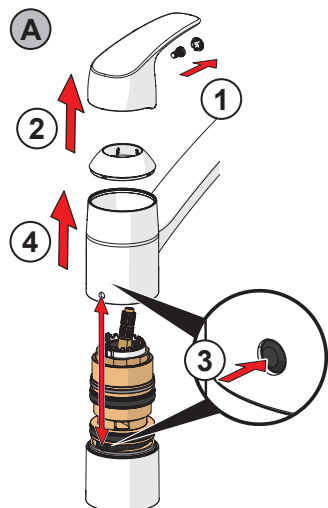

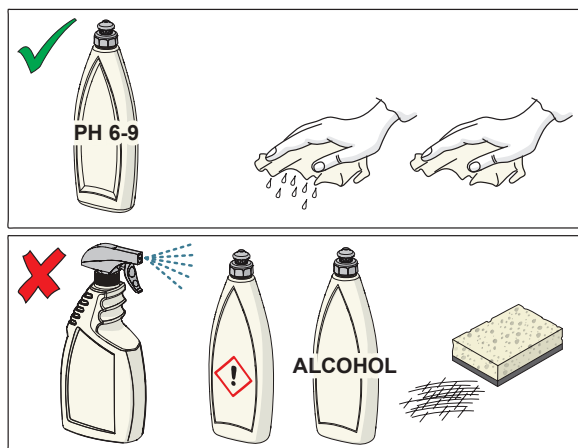
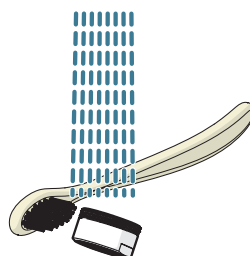
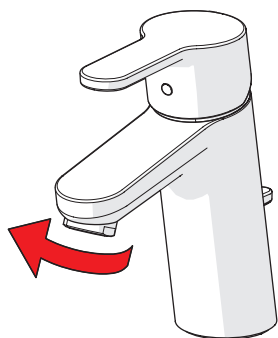

CLEANING.HANSA.COM